



DNA-11-2022

HPE-11-2022

Pawsey Supercomputing Research Centre



Let's step back a bit and tell you **WHO WE ARE**



WESTERN AUSTRALIA



SAME TIMEZONE AS 1/3 OF THE WORLD



WE ARE ON THE LAND OF THE WHADJUK NOONGAR PEOPLE

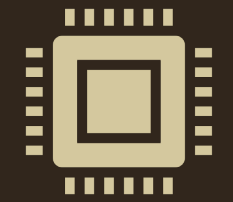

MOST POWERFUL RESEARCH SUPERCOMPUTER IN THE SOUTHERN HEMISPHERE

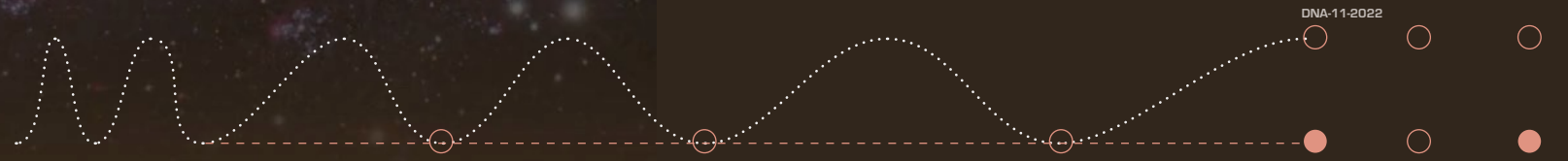



May 5-9, 2024



CUG2024
Diverse Universe

PERTH AUSTRALIA



SETOPIX

HPE Cray

HPE Cray

HPE Cray

HPE Cray

HPE Cray

HPE Cray

HPE Cray

HPE Cray

HPE Cray





9PB Ceph storage
3000+ vCores
An overview of Setonix

Nimbus (Cloud)

100 Gbps



200,000+ Cores,
700+ GPUs, 100Gbps

Setonix Supercomputer

100 Gbps



Topaz GPU Cluster

10 Gbps



ASKAP Ingest

10 Gbps

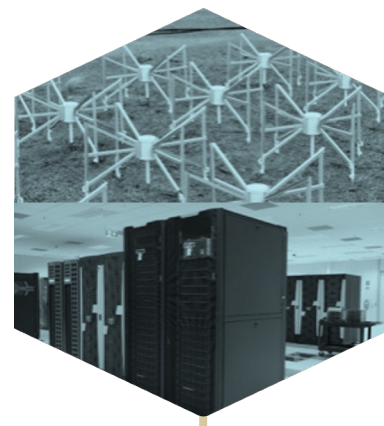

Garrawarla

10 Gbps



100 Gbps

100 Gbps
External Firewall



S3 Interface

Fibre Channel

70 PB tape system



100Gbps

60 PB Ceph Object Store



Advanced
architecture

-
-
-
-



A future where Australian research plays a vital role



A future driven by a workforce of diverse, digitally ready, data-savvy people

A future that is inclusive, where the advantages of supercomputers are available to all

We are ready for the future — but what will it look like?



How will we reach our future potential?

WE ARE ALREADY ON OUR WAY.

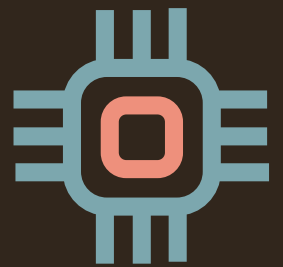

DIAMOND BASED
QUANTUM
ACCELERATOR



CUTTING-EDGE
QUANTUM
APPLICATIONS



PAWSEY PIONEERS
PROGRAM



UPSKILLING FOR
RESEARCHERS

GETTING TO PERTH, WESTERN AUSTRALIA



Visas to visit Australia

- For the latest information on the Visa you may need to enter Australia, visit:
 - immi.homeaffairs.gov.au/visas/getting-a-visa/visa-listing/electronic-travel-authority-601
 - immi.homeaffairs.gov.au/visas/getting-a-visa/visa-finder/visit
 - Pawsey will be happy to provide a letter of support if required
- You must apply for the Visa using the Australian ETA app: immi.homeaffairs.gov.au/visas/getting-a-visa/visa-listing/electronic-travel-authority-601#HowTo
 - Apple store: <https://apps.apple.com/au/app/australianeta/id1527982364>
 - Google Play store: https://play.google.com/store/apps/details?id=au.gov.homeaffairs.eta&hl=en_AU&gl=US&pli=1

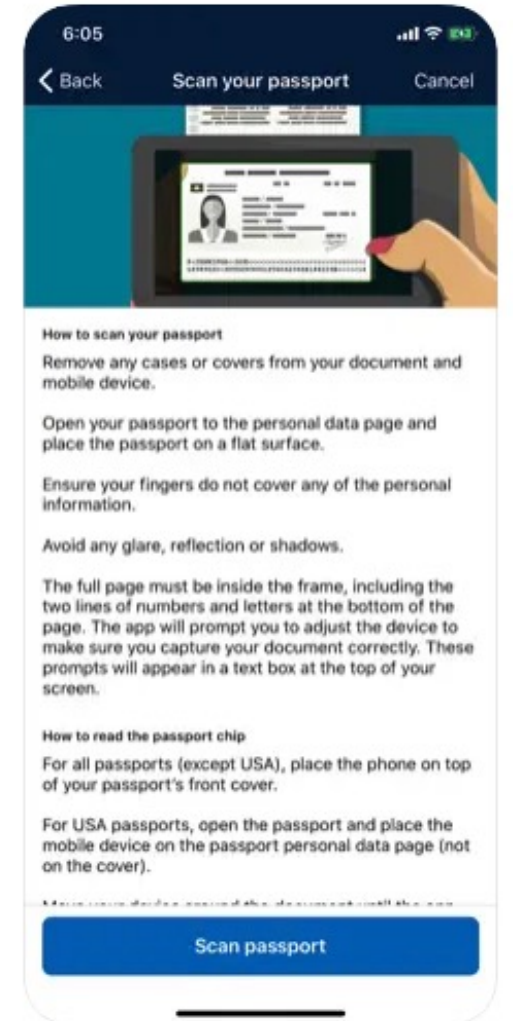



PERTH IS



Points of Interest in Perth

Rottneest Island sits just offshore from the city of Perth, in Western Australia. A protected nature reserve, it's home to the quokka, a small wallaby-like marsupial. White-sand beaches and secluded coves include the Basin, with its shallow waters, and Thomson Bay, the main hub and ferry port. Strickland Bay is known for its surf breaks, while reef breaks occur at Radar Reef, off the island's far western tip

Kings Park and Botanic Garden Bigger than Central Park in New York and altogether wilder, Kings Park is a 1,003-acre haven of parkland, botanical gardens and natural bushland, located right on the western edge of Perth's central business district. The park is a mixture of grassed parkland, botanical gardens and natural bushland on Mount Eliza with two-thirds of the grounds conserved as native bushland. Offering panoramic views of the Swan River and Darling Range, it is home to over 324 native plant varieties, 215 known indigenous fungi species and 80 bird species. It is the most popular visitor destination in Western Australia, being visited by over five million people each year.

Cottesloe Beach is a popular beach in Cottesloe and one of the most iconic locations of Western Australia. The enduring popularity of the beach is the result of combination of factors including proximity to metropolitan Perth, accessibility by train, shelter from strong summer breezes and presence of offshore reefs making it a relatively safe swimming location. It has been recognised by the Heritage Council as a place of cultural significance since 2005.

Fremantle Prison sometimes referred to as Fremantle Gaol or Fremantle Jail, is a former Australian prison and World Heritage Site in Fremantle, Western Australia. The six-hectare site includes the prison cellblocks, gatehouse, perimeter walls, cottages, and tunnels. It was initially used for convicts transported from Britain but was transferred to the colonial government in 1886 for use for locally-sentenced prisoners.

Elizabeth Quay is a mixed-use development project in the Perth central business district. Focusing on an area located on the north shore of Perth Water near the landmark Swan Bells, the precinct being developed by the project was named in honour of Queen Elizabeth coastal air make a holiday here the remedy to modern life.

Swan Valley is a region in the upper reaches of the Swan River between Guildford and Bells Rapids, Western Australia. It is bordered to the east by the Darling Scarp. Both Ellenbrook and Jane Brook lie within the region and discharge into the Swah River.

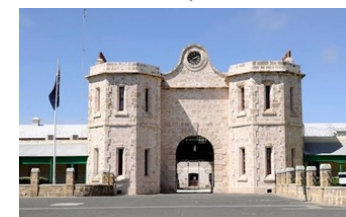
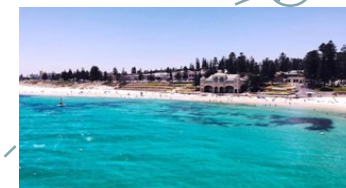



THANK YOU QUESTIONS?

